

All NATMAC Representatives

15 September 2010

File Reference: DAP/CAS/DM/CLYDETMZ

**NATMAC INFORMATIVE LETTER**

Dear Colleagues,

**AIRSPACE CHANGE PROPOSAL FRAMEWORK BRIEFING: ESTABLISHMENT OF  
TEMPORARY TRANSPONDER MANDATORY ZONE (TTMZ) AROUND THE CLYDE  
WINDFARM IN SOUTH OF SCOTLAND**

The Directorate has held a Framework Briefing with Scottish & Southern Energy (SSE) and their Seconded National Experts from NATS on a proposal to establish TTMZ around the Clyde windfarm, between Abington and Moffat in the south of Scotland – see map at Enclosure 1. The proposed vertical dimensions of the TTMZ are from 3500ft amsl to the base of controlled airspace (Scottish TMA), 5500ft amsl.

SSE has confirmed the intention to proceed with the proposal and has commenced Stage 2 & 3<sup>1</sup> (Proposal Development & Preparing for Consultation). This TTMZ is in support of measures planned to mitigate the potential effect upon NATS ATC displays of a large number of primary radar returns caused by the Clyde wind turbines. The proposal encompasses that area of extant radar coverage in Class G airspace in the TAY Sector that will be impacted by the windfarm and is a temporary measure until a newly constructed infill primary radar comes on line – estimated to be mid-late 2012

The DAP Project Leader is Dean Miller of the Controlled Airspace Section;  
[dean.miller@caa.co.uk](mailto:dean.miller@caa.co.uk), 020 7453 6554.

Yours sincerely,

*Original signed*

J C Walker  
NATMAC Secretary

Enclosure:

1. Map showing position of the Clyde windfarm.

---

<sup>1</sup> CAP 725, CAA Guidance on the Application of the Airspace Change Process

**PROPOSED TEMPORARY TRANSPONDER MANDATORY ZONE OVER THE CLYDE WINDFARM DEVELOPMENT**

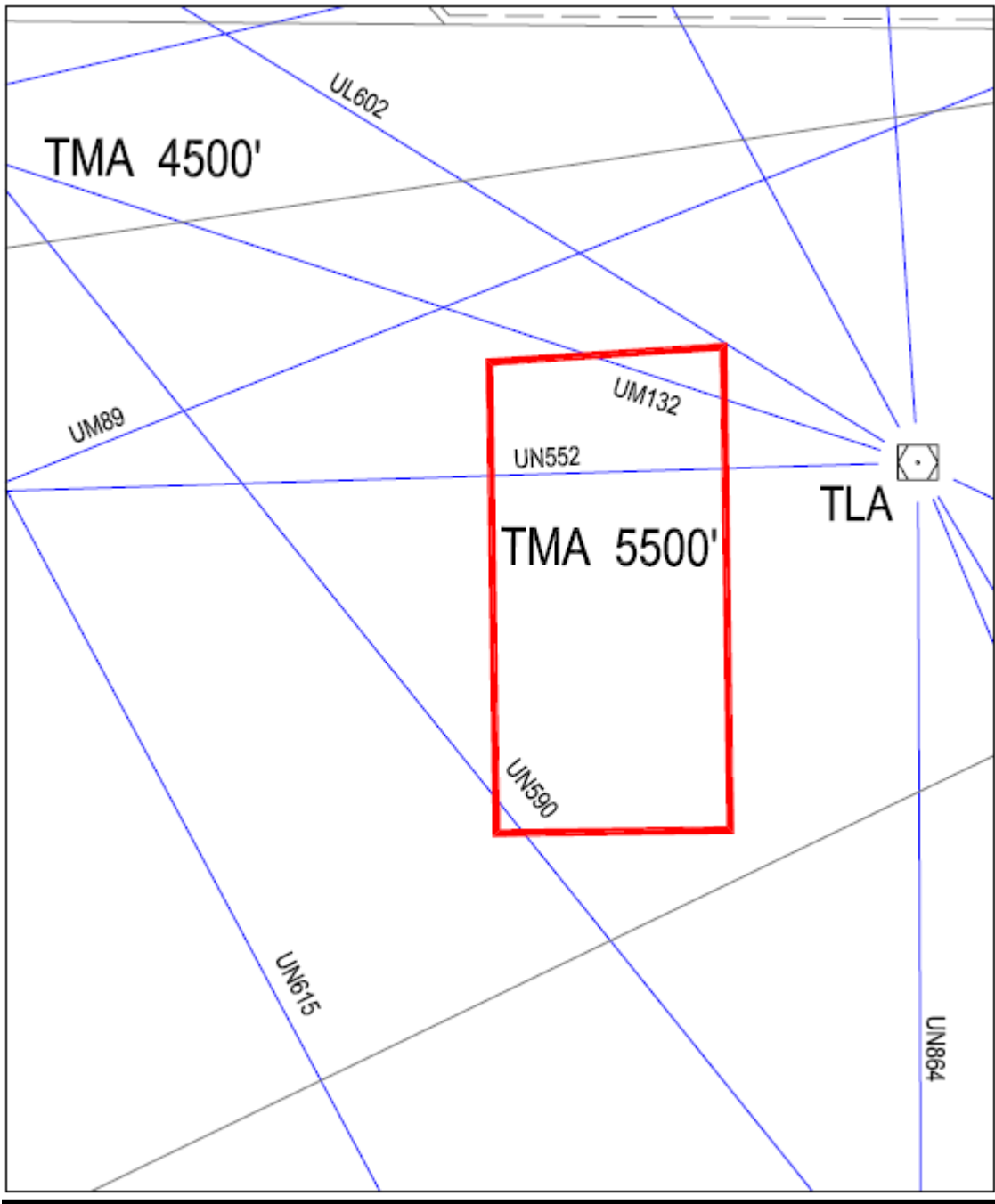

# PROPOSED TEMPORARY TMZ

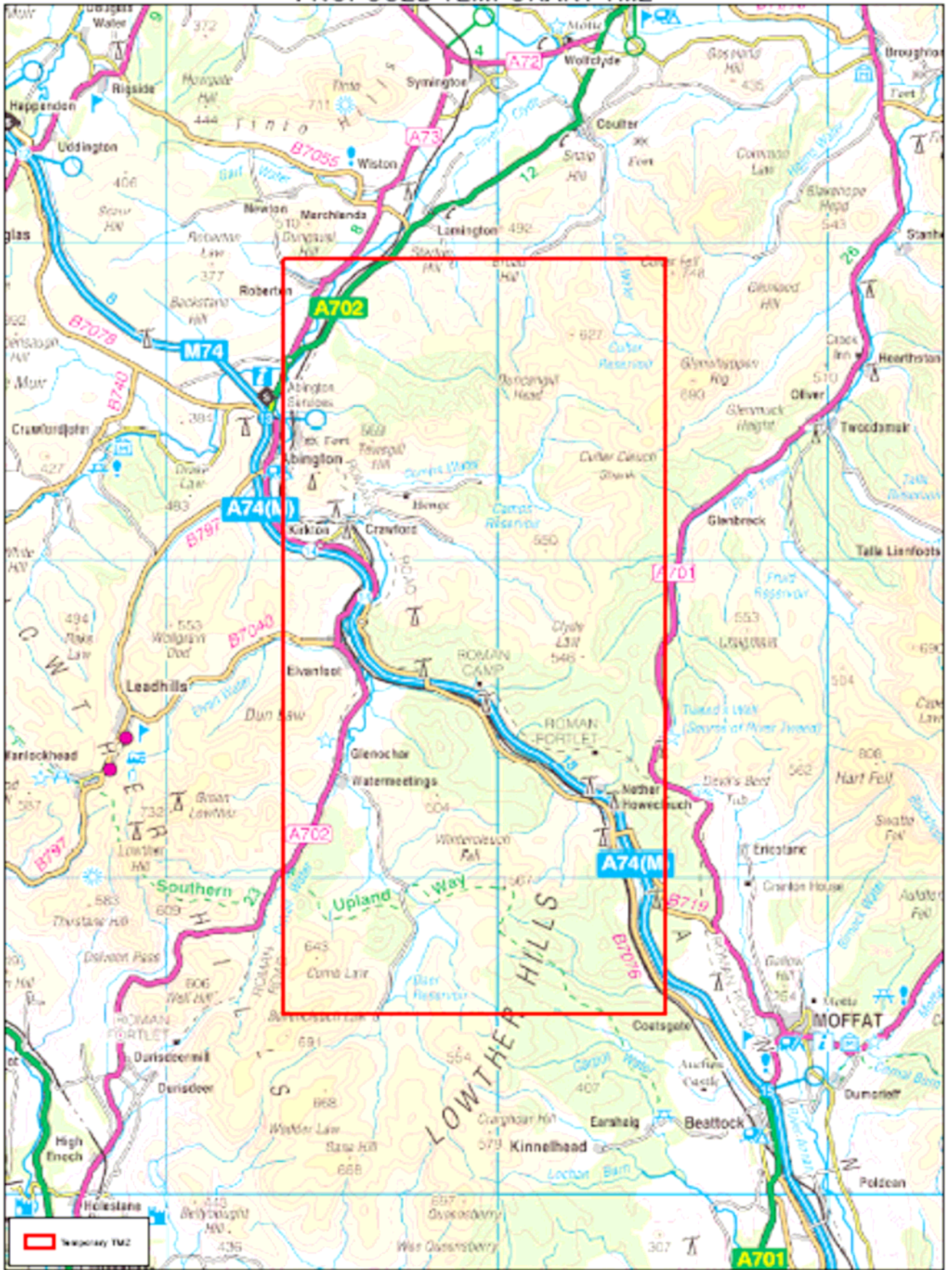

Based upon the Ordnance Survey Map with the permission of the controller of Her Majesty's Stationary Office  
 Crown copyright reserved.



## VERTICAL VIEW OF PROPOSED AIRSPACE CHANGE

